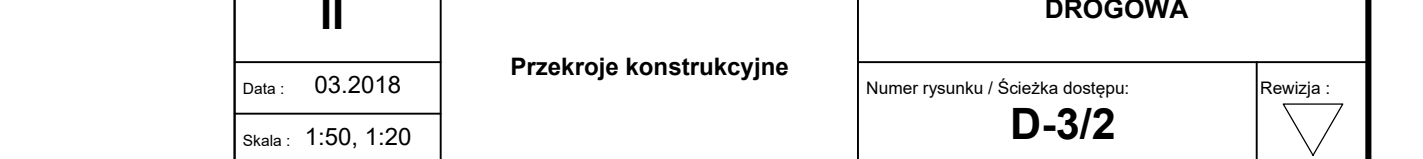
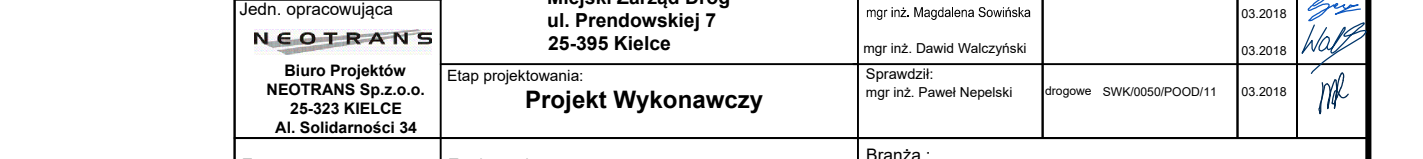
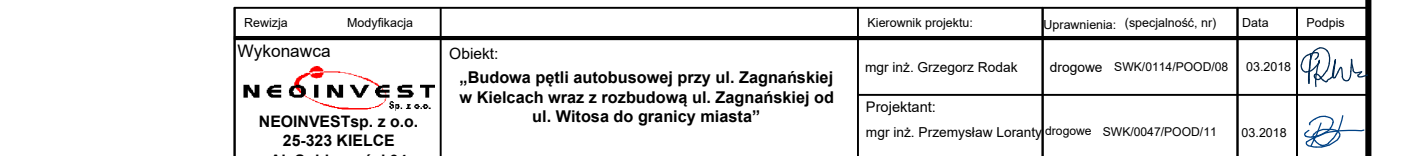
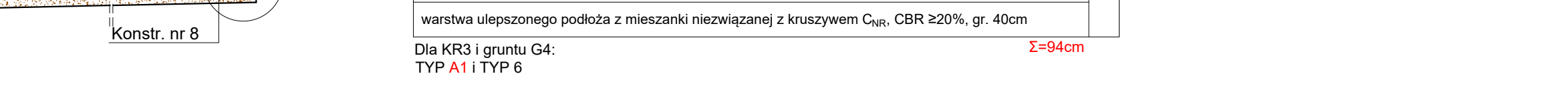
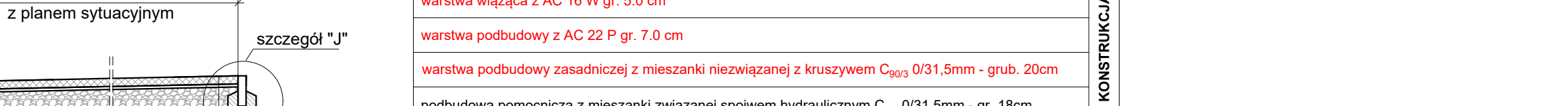
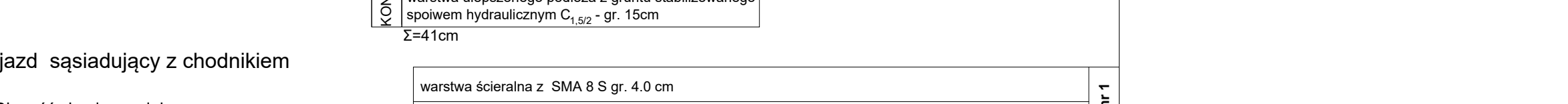
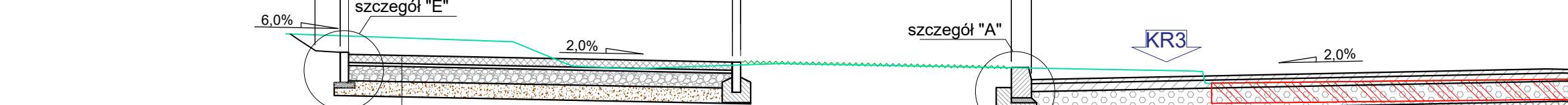
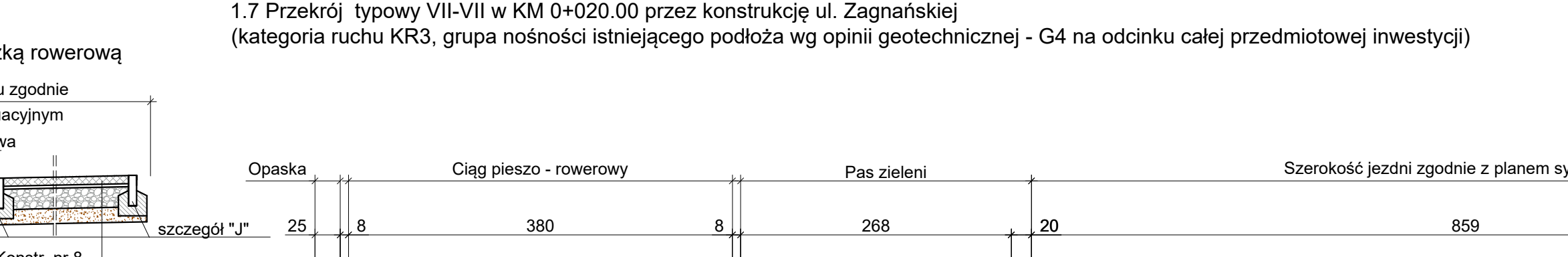
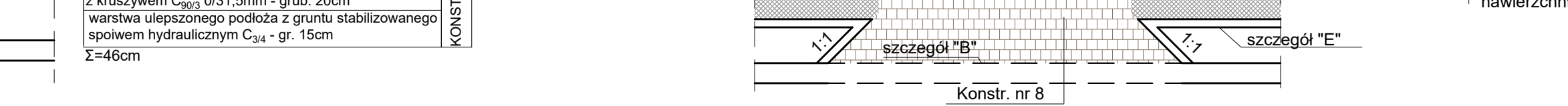
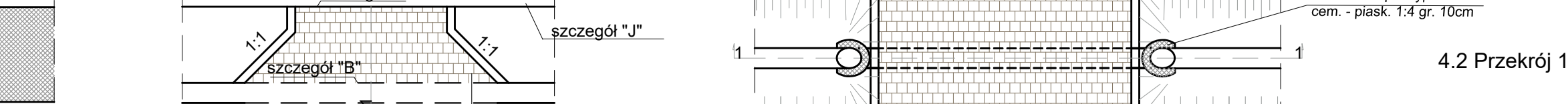
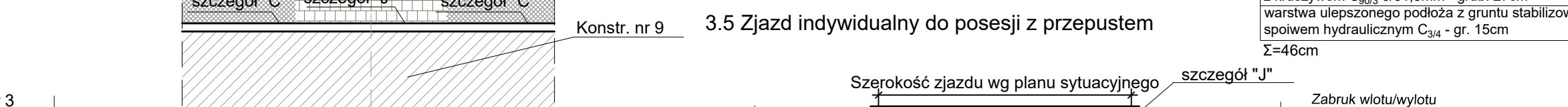
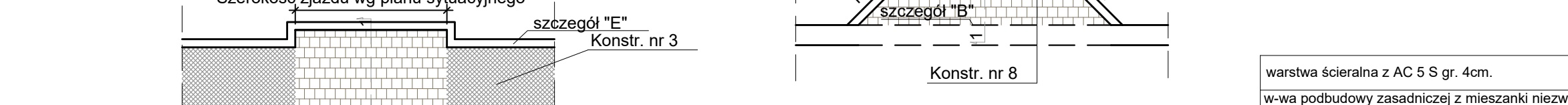
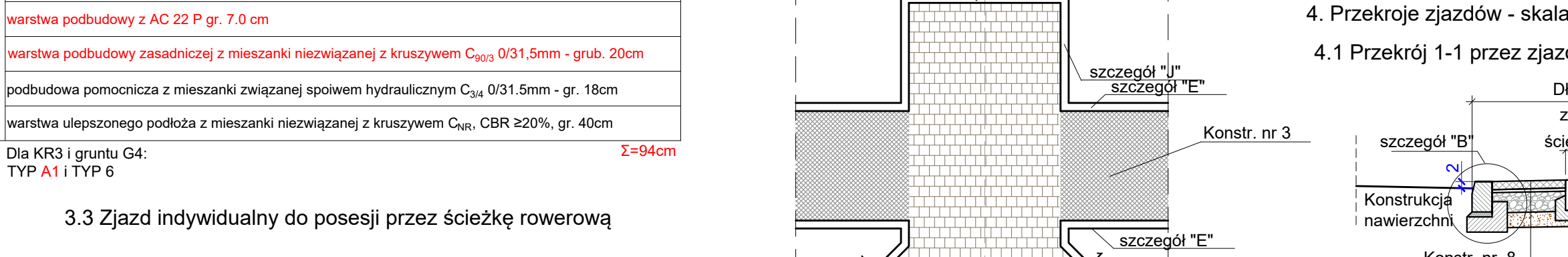
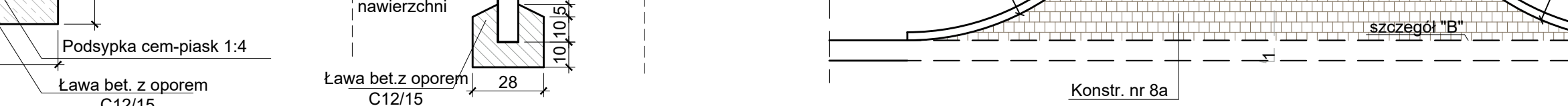
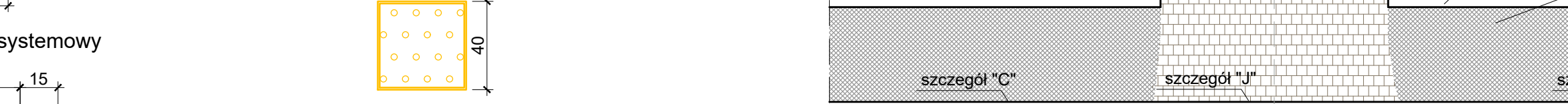
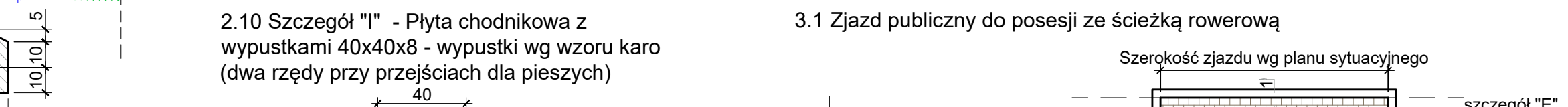
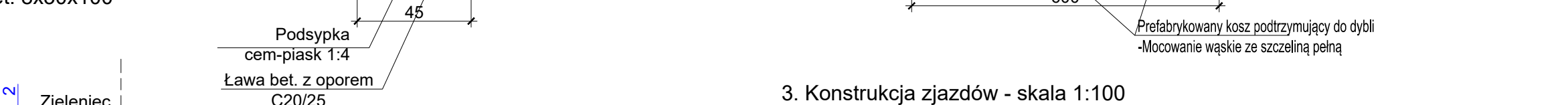
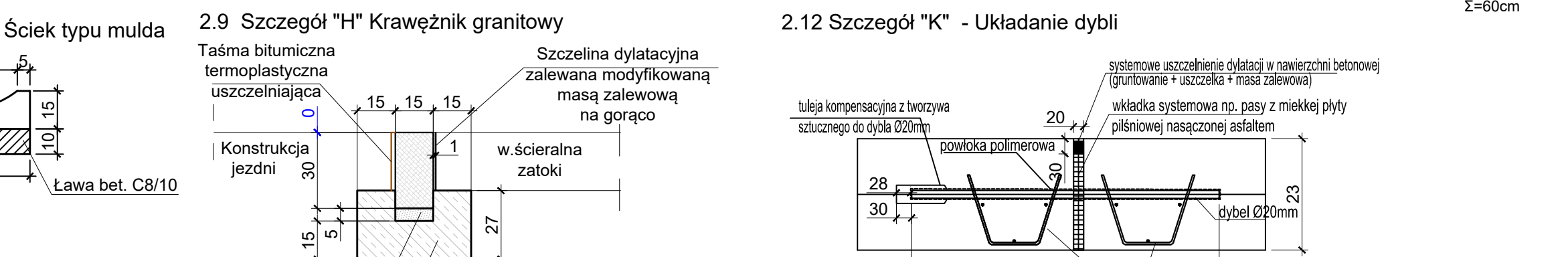
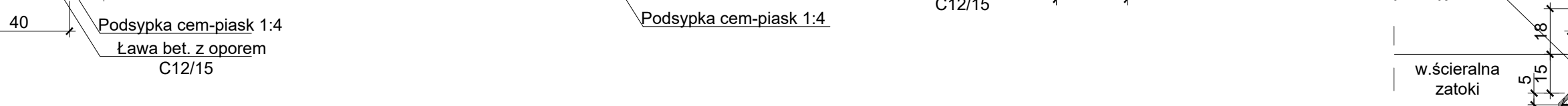
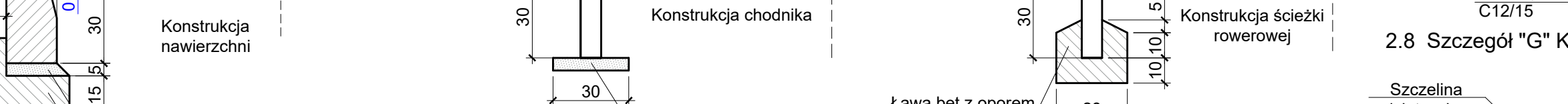
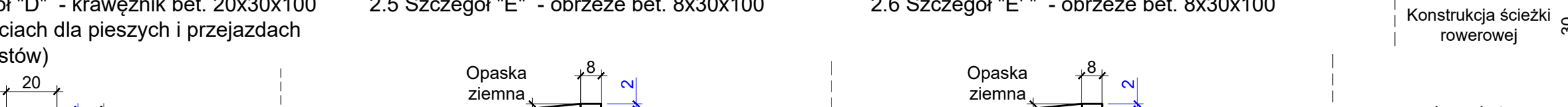
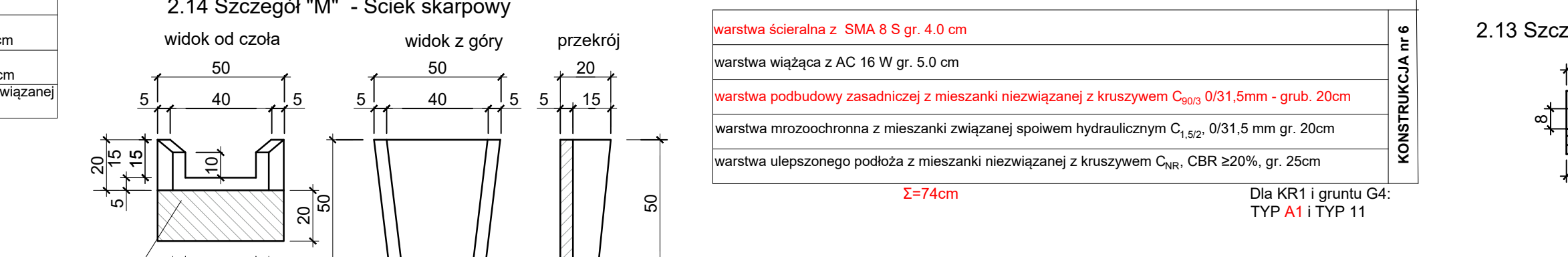
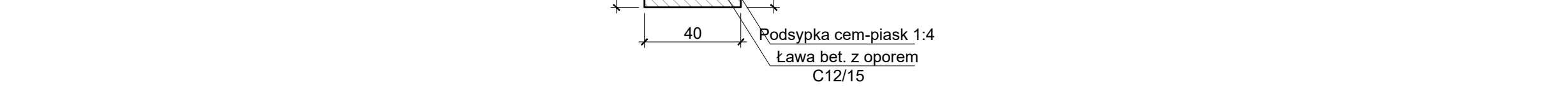
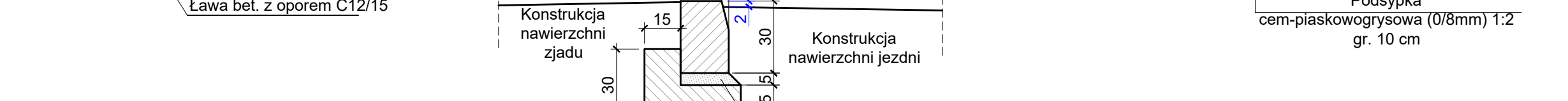
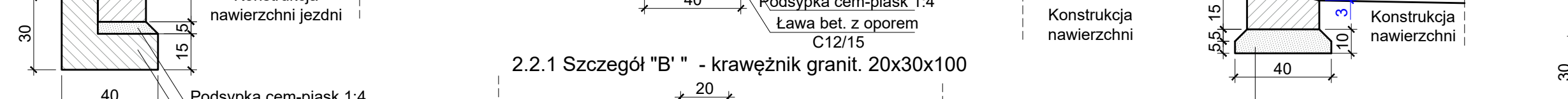
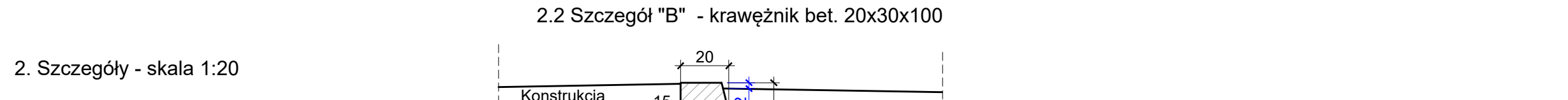
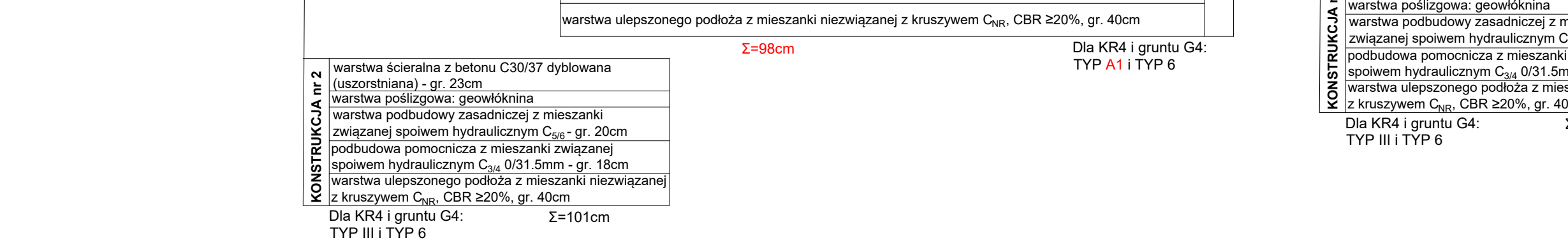
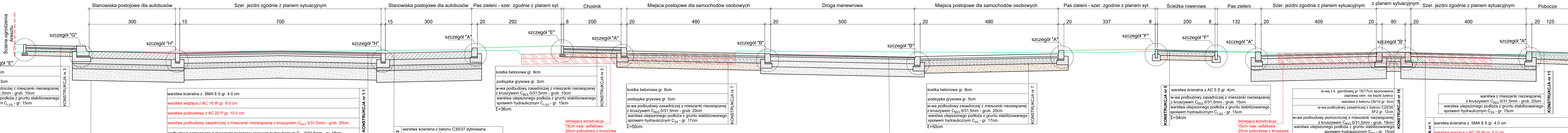

1.5 Przekrój typowy IV-IV w KM 1+276.00 przez konstrukcję ul. Zagnańskiej, pętli autobusowej i parkingu (kategoria ruchu KR3 - ul. Zagnańska, KR4 - jezdnia pętli autobusowej, KR1 - jezdnia manewrowa parkingu, grupa nośności istniejącego podłoża wg opinii geotechnicznej - G4 na odcinku całej przedmiotowej inwestycji)

[illegible]